

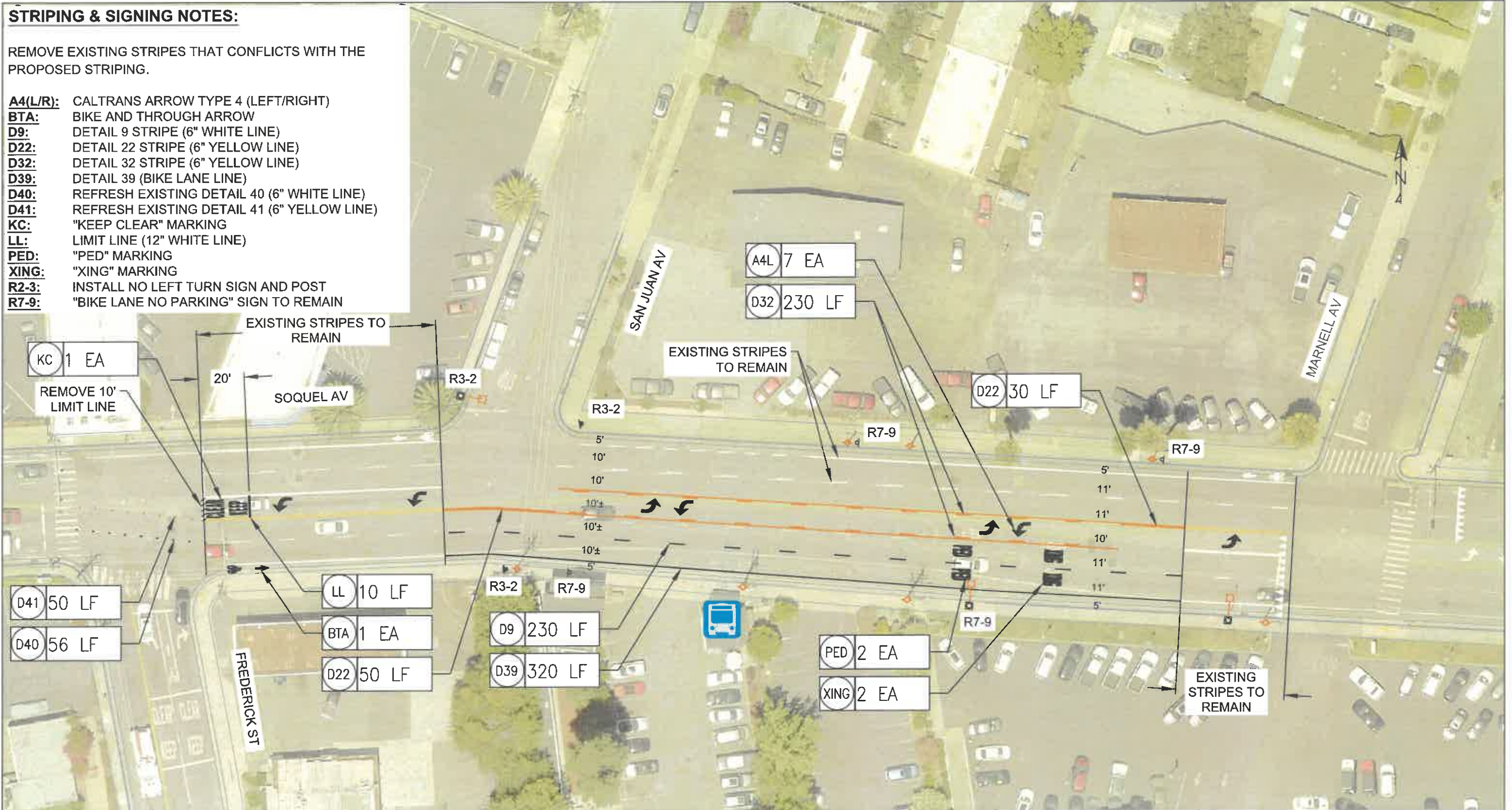

STRIPING & SIGNING NOTES:

REMOVE EXISTING STRIPES THAT CONFLICTS WITH THE PROPOSED STRIPING.

- A4(L/R):** CALTRANS ARROW TYPE 4 (LEFT/RIGHT)
- BTA:** BIKE AND THROUGH ARROW
- D9:** DETAIL 9 STRIPE (6" WHITE LINE)
- D22:** DETAIL 22 STRIPE (6" YELLOW LINE)
- D32:** DETAIL 32 STRIPE (6" YELLOW LINE)
- D39:** DETAIL 39 (BIKE LANE LINE)
- D40:** REFRESH EXISTING DETAIL 40 (6" WHITE LINE)
- D41:** REFRESH EXISTING DETAIL 41 (6" YELLOW LINE)
- KC:** "KEEP CLEAR" MARKING
- LL:** LIMIT LINE (12" WHITE LINE)
- PED:** "PED" MARKING
- XING:** "XING" MARKING
- R2-3:** INSTALL NO LEFT TURN SIGN AND POST
- R7-9:** "BIKE LANE NO PARKING" SIGN TO REMAIN



REVISIONS



CITY OF SANTA CRUZ
PUBLIC WORKS DEPARTMENT
809 Center Street, Room 201
Santa Cruz, CA 95060

SOQUEL AVENUE
MINOR STRIPING IMPROVEMENTS 2025
FREDERICK STREET

REFERENCES FIELD BOOK: # DRAWING #:	DATE 12/03/25
	DRAWN DnC
	DESIGN DnC
	CHECKED MS

SCALE 1" = 40'
SHEET 1 OF 6
Vault No.

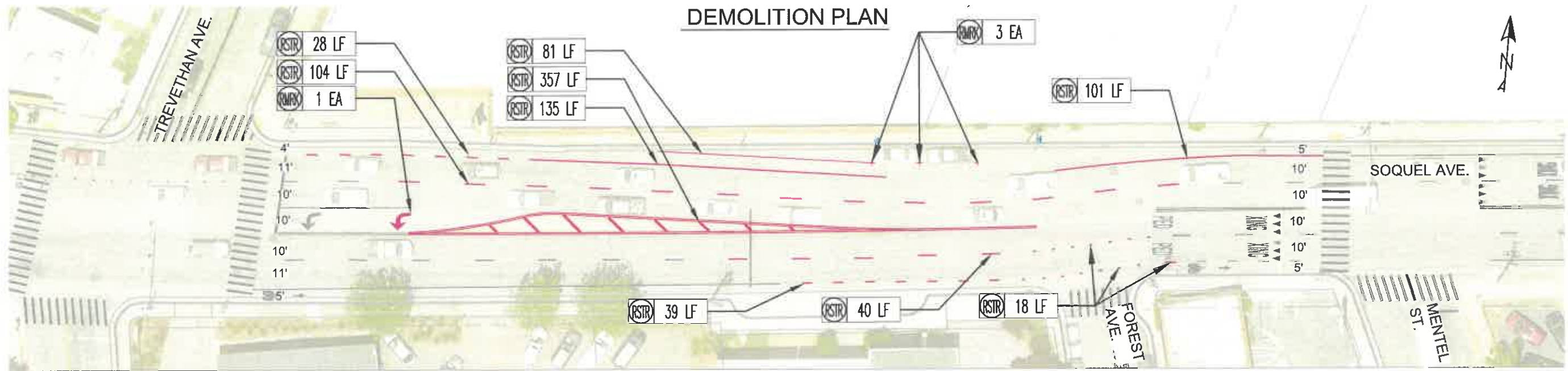

STRIPING NOTES:
BL1: BUFFERED LINE (INSIDE DETAIL 39A, OUTSIDE DETAIL 39 AND 6" WHITE HATCH, 45° ANGLE, 12' GAP
BL2: BUFFERED LINE (INSIDE DETAIL 39A/ OUTSIDE DETAIL 39A AND 6" WHITE HATCH, 45° ANGLE, 20' GAP
BL3: BUFFERED LINE (INSIDE DETAIL 39/ OUTSIDE DETAIL 39 AND 6" WHITE HATCH, 45° ANGLE, 20' GAP
D8: DETAIL 8 LANE LINE
D22: DETAIL 22 CENTERLINE
D28: DETAIL 28 MEDIAN ISLAND

D39A: DETAIL 39A DASHED BIKE LANE
D39: DETAIL 39 BIKE LANE
D40: DETAIL 40 LANE LINE EXTENSION
HL6Y: 6 INCH YELLOW STRIPE HATCH, 45°, 10' O.
LL: 12" LIMIT LINE
RMRK: REMOVE PAVEMENT MARKING
RSTR: REMOVE STRIPING
T4LA: LEFT TURN ARROW

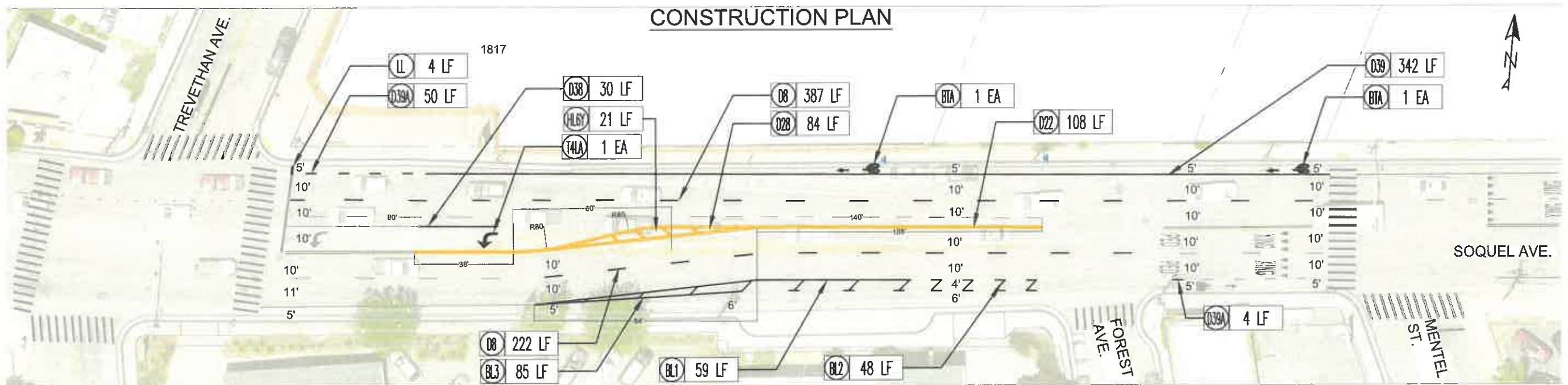

REVISIONS



CITY OF SANTA CRUZ
 PUBLIC WORKS DEPARTMENT
 809 Center Street, Room 201
 Santa Cruz, CA 95060

SOQUEL AVENUE
 MINOR STRIPING IMPROVEMENTS 2025
 TREVETHAN AVE. - MENTEL ST.

REFERENCES	DATE	12/03/25
FIELD BOOK: #	DRAWN	CM
DRAWING #:	DESIGN	CM
	CHECKED	MS

SCALE	1" = 40'
SHEET	2 OF 6
Vault No.	

DEMOLITION PLAN

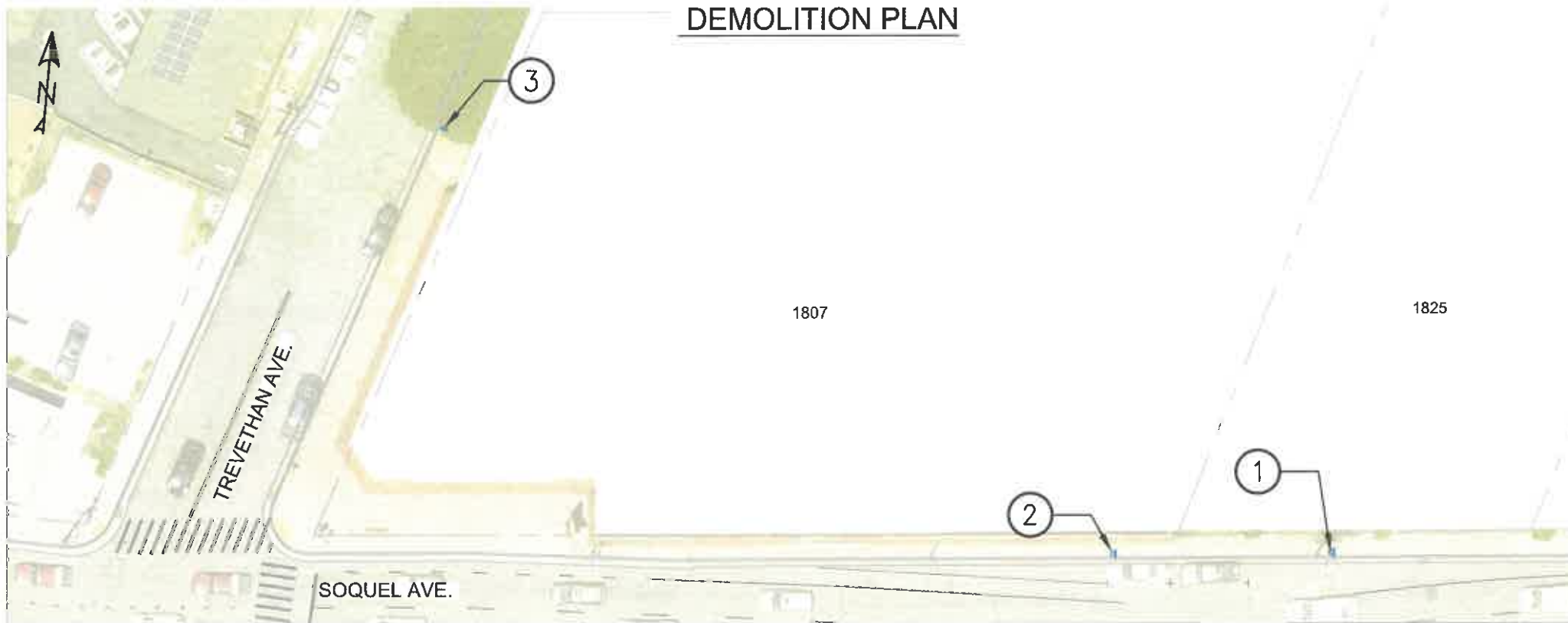

DEMOLITION NOTES:

- 1) REMOVE (E) R32C (CA) SIGN AND (E) CITY POST. GRIND POST FLUSH WITH SIDEWALK. SEE DETAIL 1.
- 2) REMOVE (E) R32C (CA) SIGN, (E) R81B "END" PLAQUE AND (E) R81A "BEGIN" PLAQUE. LEAVE (E) R7-9 SIGN ON (E) CITY POST. SEE DETAIL 1, DETAIL 2, DETAIL 7, AND DETAIL 10.
- 3) REMOVE (E) R30 (CA) SIGN AND (E) R81A "BEGIN" PLAQUE FROM (E) CITY POST. SEE DETAIL 5 AND DETAIL 7.

CONSTRUCTION PLAN

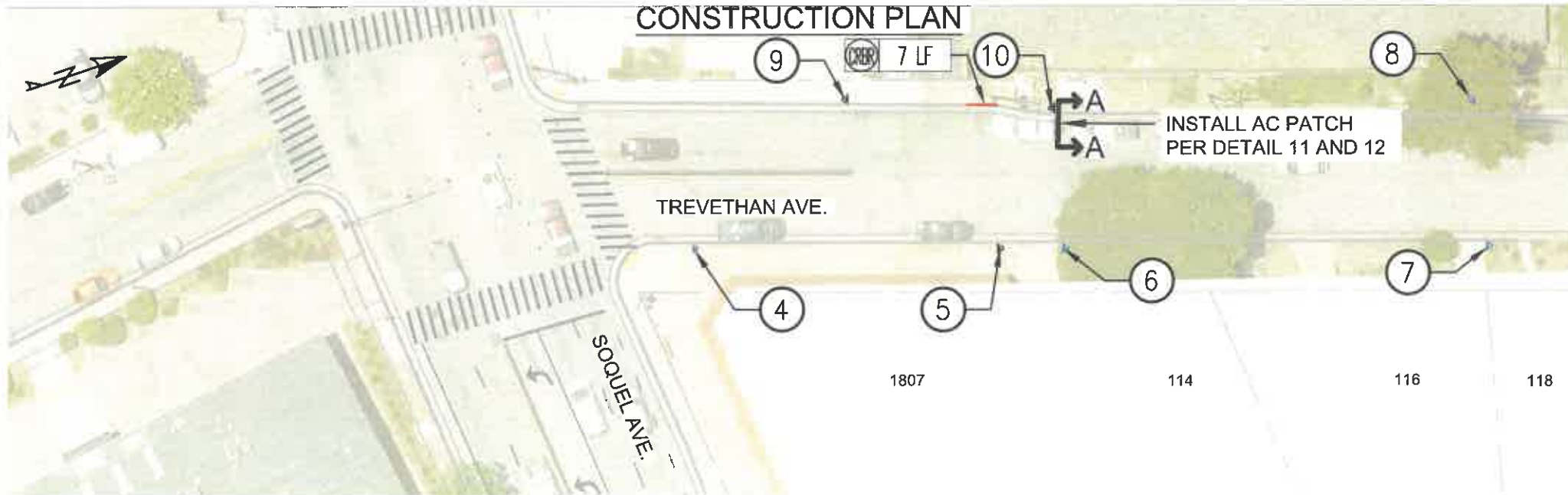

CONSTRUCTION NOTES:

- 4) INSTALL (N) R32C (CA) SIGN WITH (N) R81A "BEGIN" PLAQUE ON (N) CITY POST. SEE DETAIL 1, DETAIL 9, DETAIL 12.
- 5) INSTALL (N) R32C (CA) SIGN WITH (N) R81B "END" PLAQUE ON (N) CITY POST. SEE DETAIL 1, DETAIL 10, DETAIL 12.
- 6) INSTALL (N) R32C (CA) SIGN WITH (N) R81A "BEGIN" PLAQUE ON (E) CITY POST. SEE DETAIL 4, DETAIL 9, AND DETAIL 12.
- 7) INSTALL (N) R32C (CA) SIGN WITH (N) R81B "END" PLAQUE ON (E) CITY POST. KEEP (E) R30 (CA) AND W84 MODIFIED SIGN IN PLACE. INSTALL (E) R81A "BEGIN" PLAQUE FROM BELOW (E) R30 SIGN. SEE DETAIL 4, DETAIL 7, DETAIL 10, DETAIL 12 AND DETAIL 13. EXTEND (E) CITY POST IF NEEDED.
- 8) INSTALL (N) R32C (CA) SIGN WITH (N) R81A "BEGIN" PLAQUE AND (N) OVO STREET SEGMENT SIGN ON (E) CITY POST. KEEP (E) R30 SIGN AND R81B "END" PLAQUE IN PLACE. SEE DETAIL 1, DETAIL 3, DETAIL 5, DETAIL 8, DETAIL 9 AND DETAIL 12.
- 9) INSTALL (N) R32C (CA) SIGN WITH (N) R81B "END" PLAQUE AND (N) OVO STREET SEGMENT SIGN ON (N) CITY POST. SEE DETAIL 1, DETAIL 3, DETAIL 10 AND DETAIL 12.
- 10) INSTALL (N) R32C (CA) SIGN AND (N) OVO STREET SEGMENT SIGN ON (N) CITY POST. SEE DETAIL 1, DETAIL 3 AND DETAIL 12.

STRIPING NOTES:

CRBR: RED CURB ■



REVISIONS

NO.	DATE	DESCRIPTION



CITY OF
SANTA CRUZ
PUBLIC WORKS DEPARTMENT
809 Center Street, Room 201
Santa Cruz, CA 95060

SOQUEL AVENUE

MINOR STRIPING IMPROVEMENTS 2025

TREVETHAN AVE. - MENDEL ST.

REFERENCES

FIELD BOOK:

DRAWING #:

DATE 12/03/25

DRAWN CM

DESIGN CM

CHECKED MS

SCALE 1" = 40'

SHEET 3 OF 6

VAULT NO.

DETAIL 8

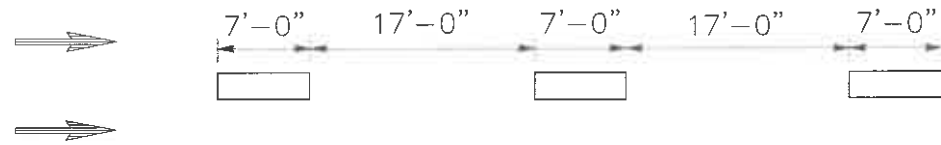

DETAIL A - DETAIL 8 (CALTRANS)

BIKE LANE LINE

DETAIL 39

6" White Line



DETAIL C - DETAIL 39 (CALTRANS)

DETAIL 29

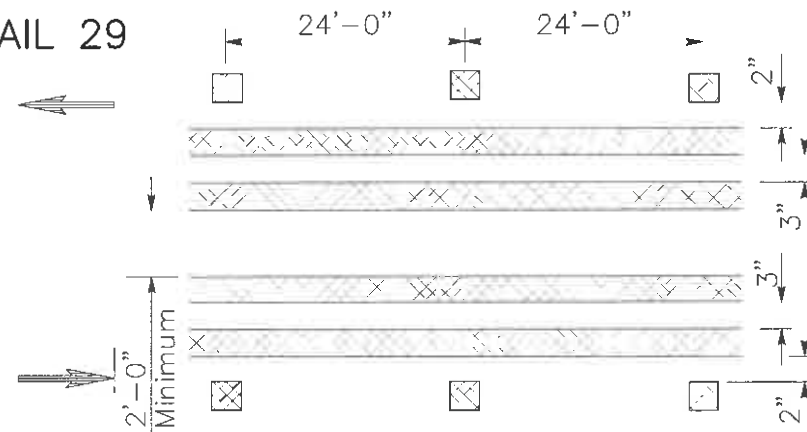

DETAIL B - DETAIL 8 (CALTRANS)

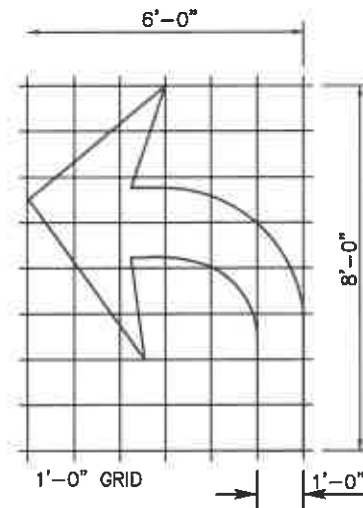

A=15 SF
TYPE IV (L) ARROW
For Type II (R) arrow, use mirror image.

DETAIL E - TYPE IV (L) ARROW (CALTRANS)

INTERSECTION LINE
BIKE LANE

DETAIL 39A

200'-0"

Intersection

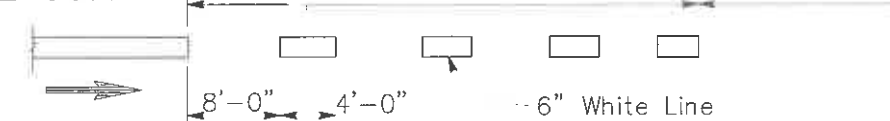

DETAIL D - DETAIL 39A (CALTRANS)

LEGEND

MARKERS

- ⊙ TYPE AY Yellow Non-reflective
- ⊠ TYPE D Two-way Yellow Retroreflective
- TYPE H One-way Yellow Retroreflective

LINES

- ▭ 4" White
- ▨ 4" Yellow
- ← Direction of Travel



REVISIONS

No.	Description



CITY OF
SANTA CRUZ
PUBLIC WORKS DEPARTMENT
809 Center Street, Room 201
Santa Cruz, CA 95060

SOQUEL AVENUE

MINOR STRIPING IMPROVEMENTS 2025

STRIPING DETAILS

REFERENCES

FIELD BOOK: #
DRAWING#:

DATE 12/03/25

DRAWN CM

DESIGN CM

CHECKED MS

SCALE NTS

SHEET 4 OF 6

VAULT NO.



DETAIL 1 - R32C (CA) MUTCD SIGN



DETAIL 2 - R7-9 (CA) MUTCD SIGN

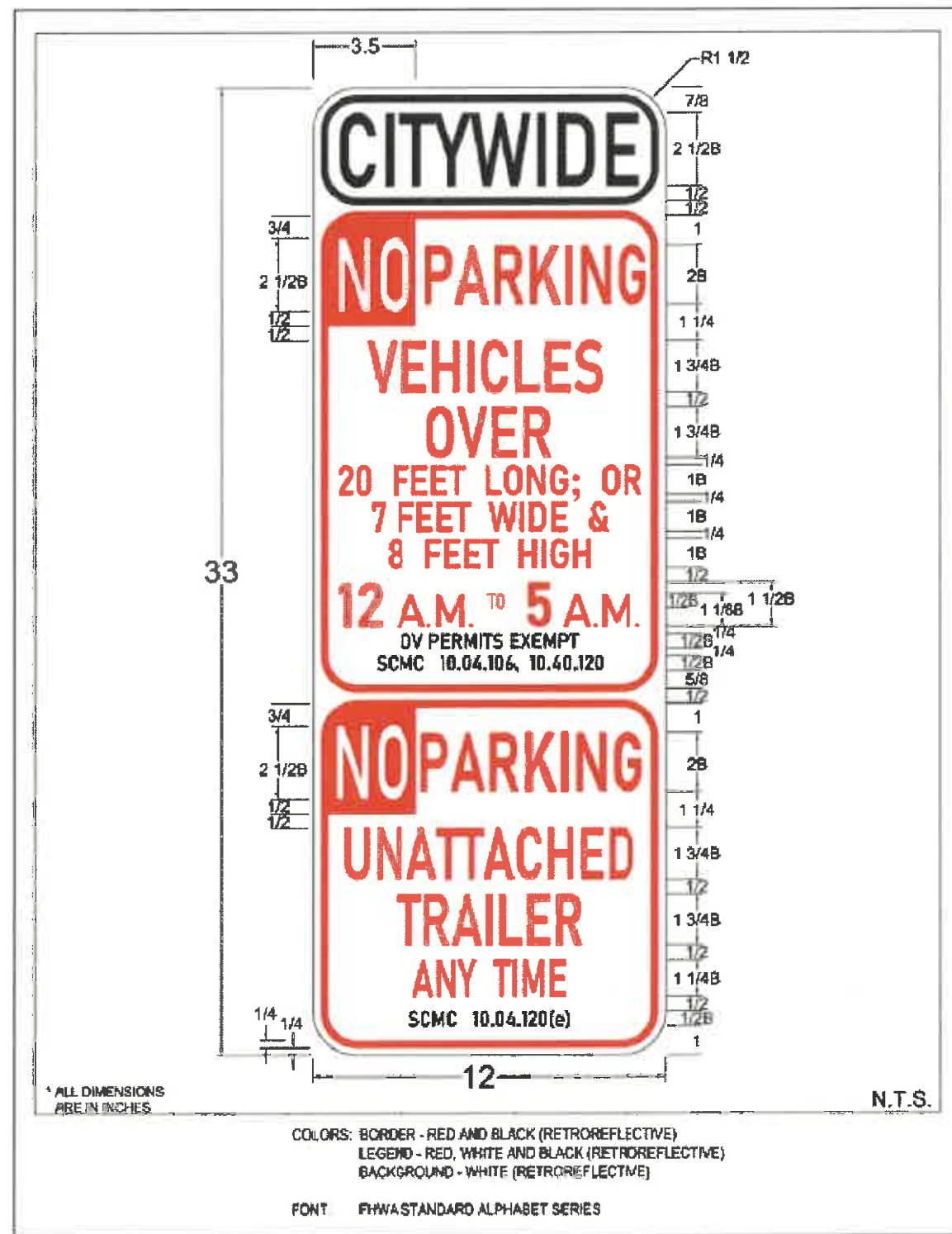

DETAIL 3 - STREET SEGMENT OVO SIGN



DETAIL 4 - R32C (CA) MUTCD SIGN



DETAIL 5 - R30 (CA) SIGN

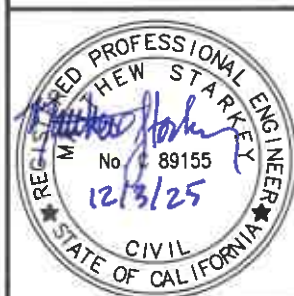

REVISIONS	



CITY OF
SANTA CRUZ
PUBLIC WORKS DEPARTMENT
809 Center Street, Room 201
Santa Cruz, CA 95060

SOQUEL AVENUE

MINOR STRIPING IMPROVEMENTS 2025

CONSTRUCTION DETAILS

REFERENCES FIELD BOOK: # DRAWING #:	DATE	12/03/25	SCALE NTS
	DRAWN	CM	
	DESIGN	CM	SHEET 5 OF 6
	CHECKED	MS	Vault No.



DETAIL 7 - RED R81A "BEGIN" PLAQUE



DETAIL 8 - RED R81B "END" PLAQUE



DETAIL 9 - GREEN R81A "BEGIN" PLAQUE



DETAIL 10 - GREEN R81B "END" PLAQUE

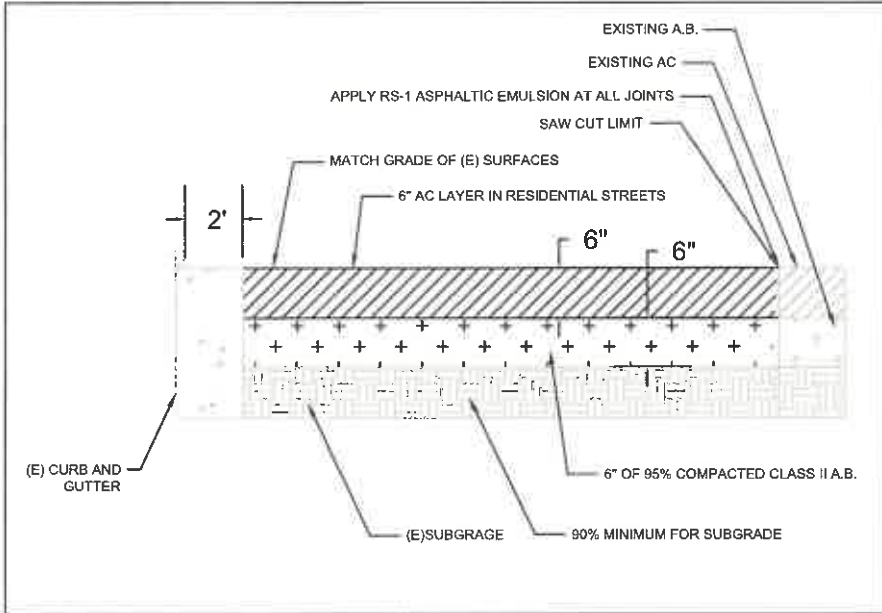

DETAIL 11 - SECTION A-A



DETAIL 13 - W84 MODIFIED SIGN

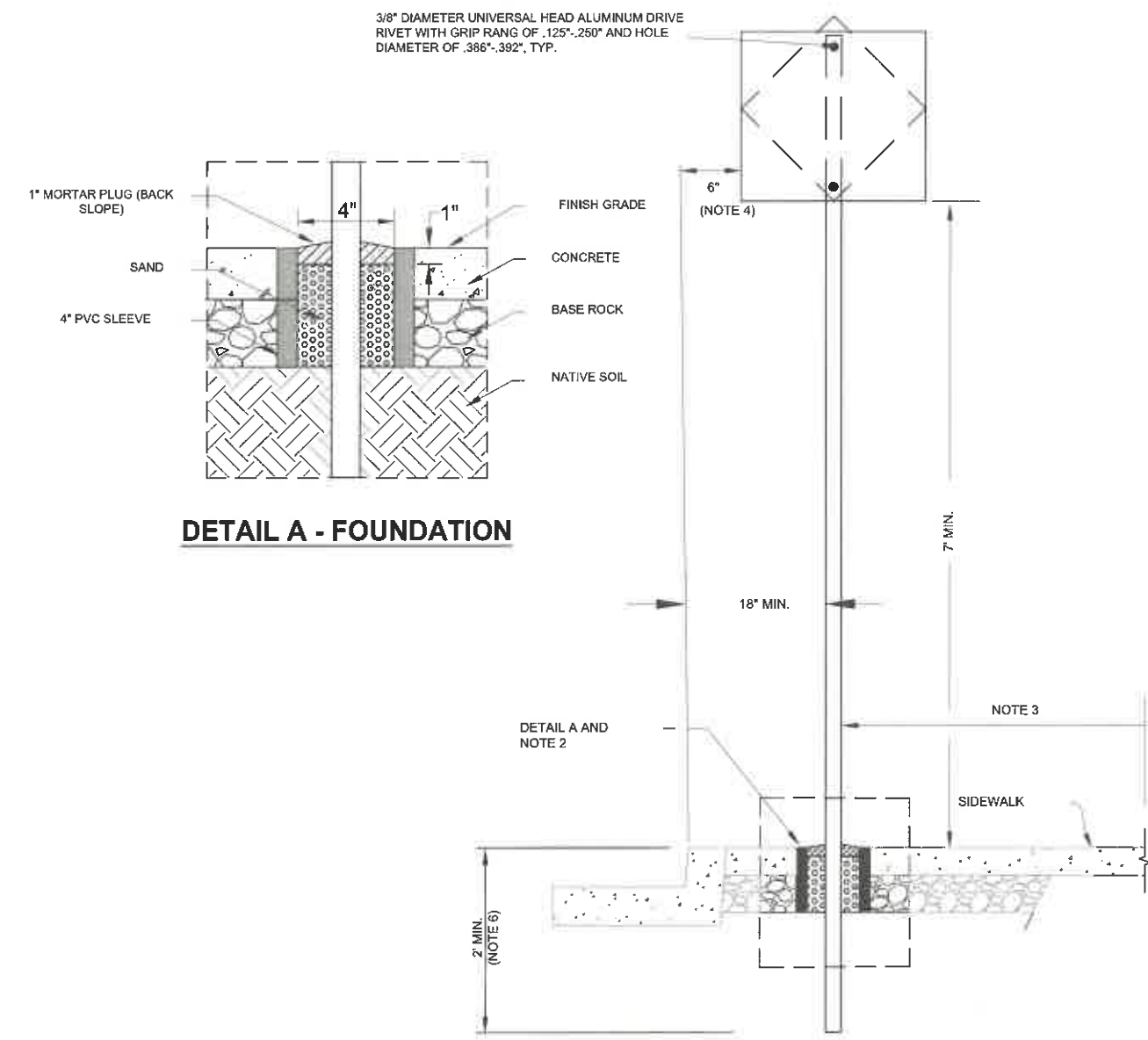

DETAIL A - FOUNDATION

POST ELEVATION

- NOTES:**
- CITY STANDARD POST SHALL BE 2" X 2" UNISTRUT "TELESPAR" PRE-DRILLED SQUARE TUBING OR APPROVED EQUAL.
 - CONTRACTOR HAS THE OPTION TO:
 - (A) 4" CORE DRILL TO NATIVE SOIL AFTER POURING CONCRETE OR
 - (B) INSTALL 4" PVC SLEEVE PRIOR TO POURING CONCRETE.
 - 4" MINIMUM CLEARANCE BETWEEN EDGE OF POST AND BACK OF WALK. POST MAY BE INSTALLED AT BACK OF WALK IF 4" CLEARANCE CAN NOT BE MET.
 - SIGN MAY BE MOUNTED OFF CENTER FROM POST TO ACCOMMODATE THE 6" SETBACK.
 - LOW PROFILE ALTERNATIVE IS 2" BELOW GRADE WITH 5" TO TOP OF SIGN (NOT ALLOWED IN PEDESTRIAN AREAS).
 - POST INSTALLED IN THE MEDIAN OR CROSSING ISLAND SHALL BE INSTALLED 2" MIN. FROM TOP OF GRADE.

DETAIL 12 - SIGN AND POST INSTALLATION STANDARD DETAIL



REVISIONS	



CITY OF
SANTA CRUZ
PUBLIC WORKS DEPARTMENT
809 Center Street, Room 201
Santa Cruz, CA 95060

SOQUEL AVENUE
MINOR STRIPING IMPROVEMENTS 2025
CONSTRUCTION DETAILS

REFERENCES	DATE	12/03/25
FIELD BOOK: #	DRAWN	CM
DRAWING #:	DESIGN	CM
	CHECKED	MS

SCALE	NTS
SHEET	6 OF 6
Vault No.	